

# CFR SERIES

## Tank Mounted Return Line Filter Assembly

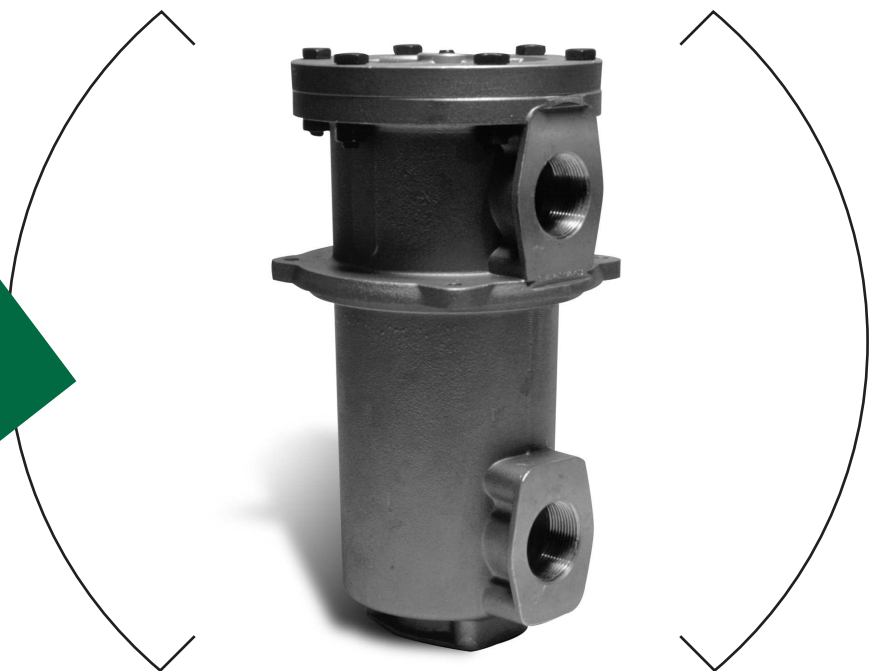

### FEATURES

---

Direct tank or line mount.

---

5 sizes-flows to 185 GPM.

---

By-pass standard. Return: 15 PSI Suction: 3 PSI

---

Aluminium die cast construction.

---

Working pressure to 300 PSI

---

Can be used for return/suction lines.

---

Suitable for mineral/petroleum based oils.

---

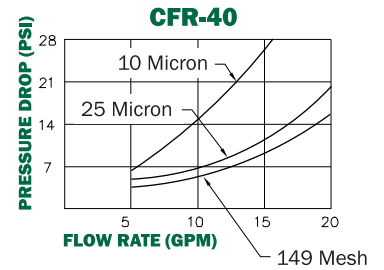
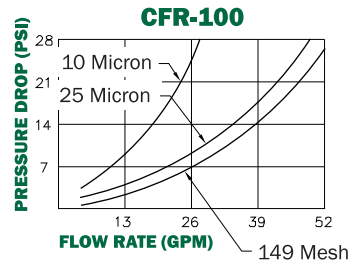
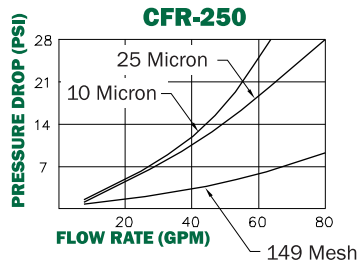
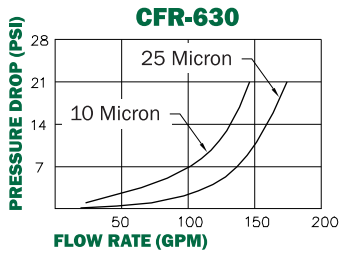

Clean element pressure drop using 150 SSU oil at 100°F.

## PRESSURE DROP

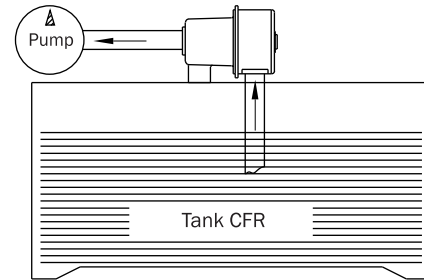
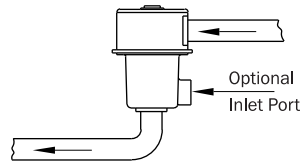
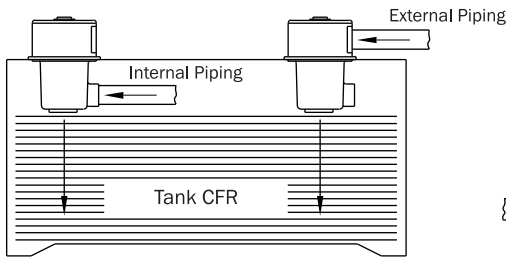

## APPLICATIONS

## DIMENSIONS

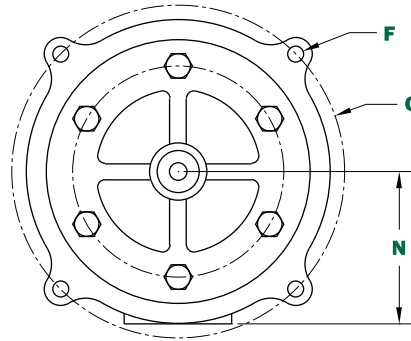
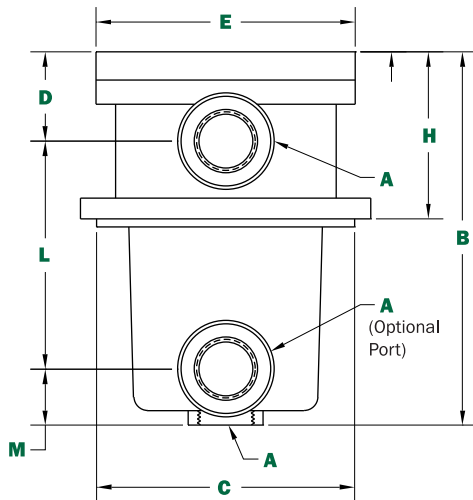

## SPECIFICATIONS

MODEL	PORT A (NPT)	DIMENSIONS										ELEMENT AREA (Sq. In.)		WT (lbs)
		B	C	D	E	F	G	H	L	M	N	10/25 $\mu$ PAPER	149 $\mu$ SS MESH	
CFR-025	1/2"	4.7"	3.31"	1.2"	3.3"	.22"	3.74"	2.0"	2.48"	.89"	2.05"	100	28	3.0
CFR-040	3/4"	6.8"	4.76"	1.6"	4.7"	.26"	5.43"	3.0"	4.13"	1.02"	2.32"	271	78	5.0
CFR-100	1"	9.5"	5.31"	2.0"	5.3"	.26"	6.06"	3.9"	5.51"	1.97"	2.64"	410	140	6.5
CFR-250	1-1/2"	13"	6.38"	2.6"	5.3"	.33"	7.09"	4.8"	6.97"	3.43"	3.15"	1225	322	12.0
CFR-630	2-1/2" SAE	15.2"	9.33"	3.2"	9.3"	.41"	10.83"	6.3"	8.58"	3.43"	6.97"	2250	542	26.0

# CFR SERIES



## Filter Tank or Line Mounted

### REPLACEMENT ELEMENTS

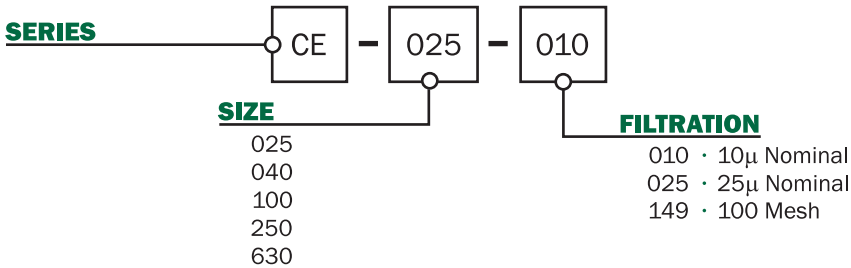

### ORDERING CODE

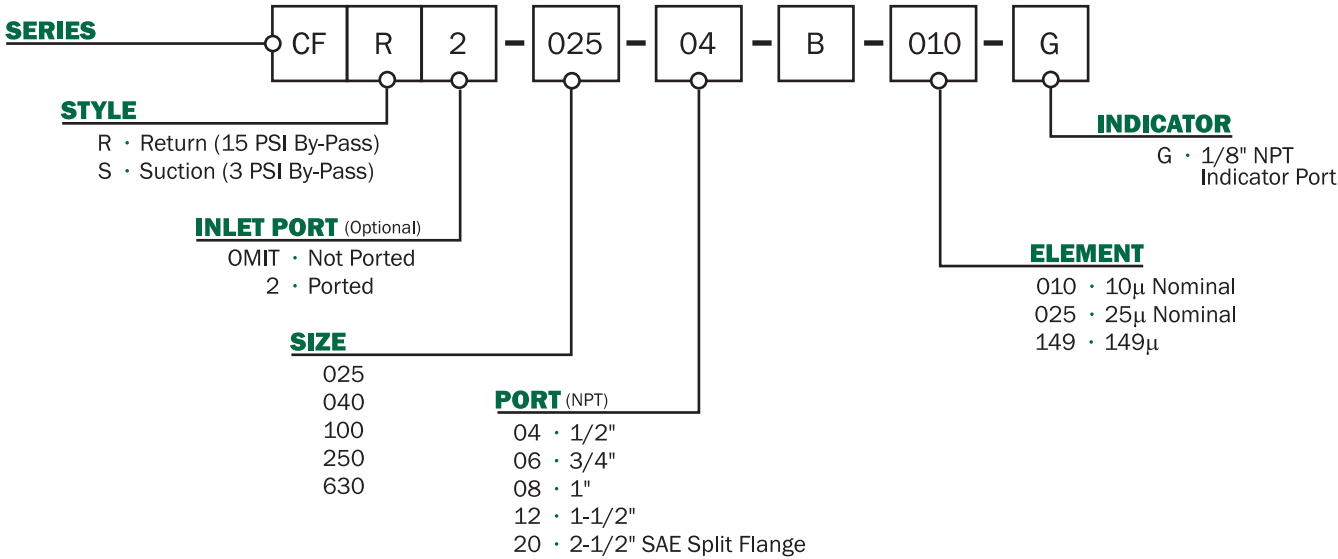

### ACCESSORIES

#### GAUGES

**P77-7003**

0-60 PSI Gauge (Indication at 15 PSI)

**P77-7004**

0-60 PSI Gauge (Indication at 25 PSI)

**P77-7021**

0-30" Hg Vacuum Gauge

#### SWITCHES

**P77-7006**

Electrical (with 12") wire leads .  
Set point (rising) 22 PSI.

**P77-7005**

Electrical (with DIN 43650)  
3 pole connection - Pressure (22 PSI).